

DOR-O-MATIC 2090 EXIT DEVICE

ROBERT BROOKE AND ASSOCIATES

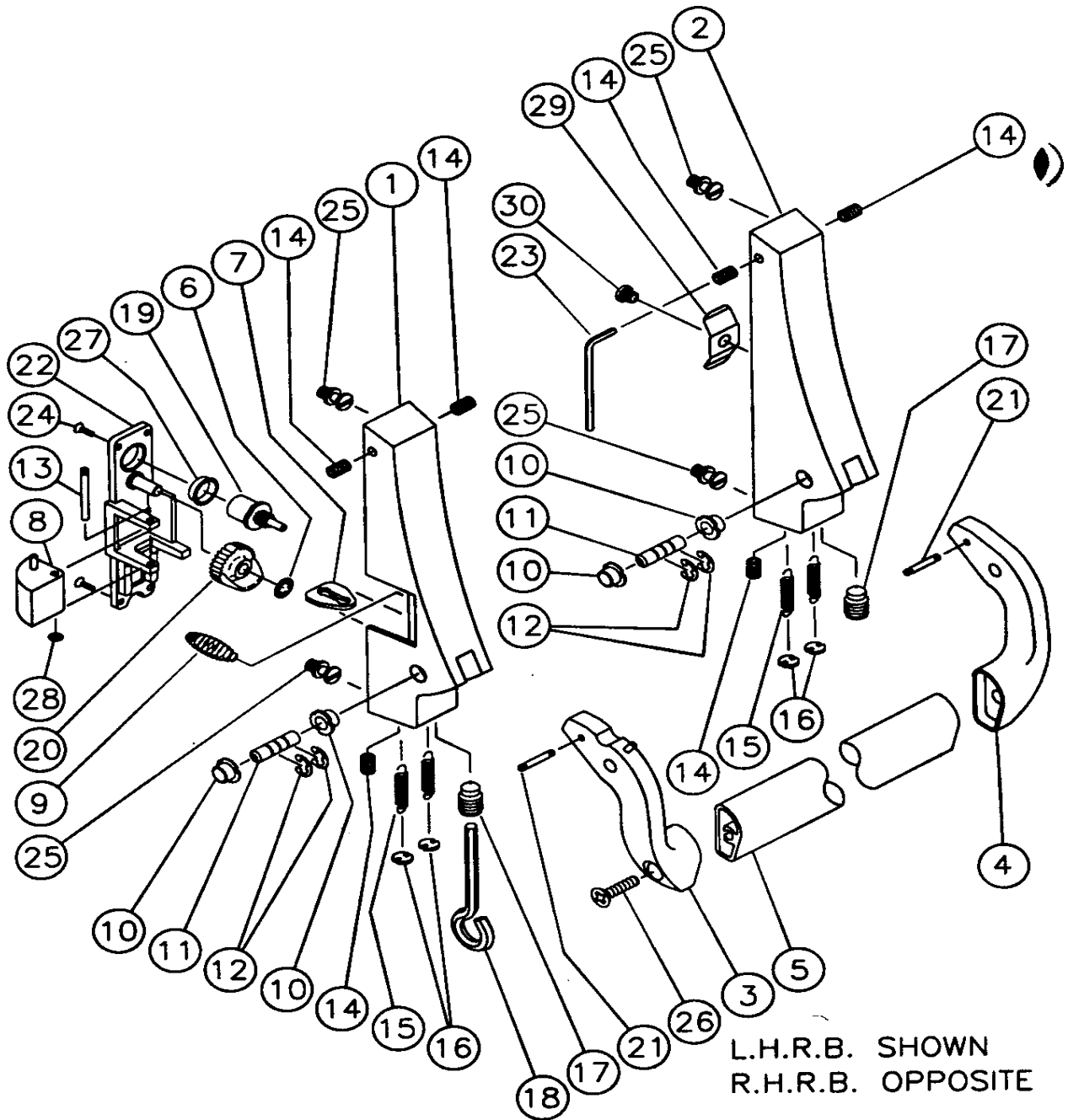

P.O. BOX 2010, BIRMINGHAM, MI 48012-2010
CALL: 1-800-642-2403 FAX: 1-800-642-2406 ASK FOR: GREG

DOR-O-MATIC 2090 EXIT DEVICE
ROBERT BROOKE AND ASSOCIATES

ITEM #	PART #	DESCRIPTION	PRICE (EA.)
1	G209001R	ACT. CASE HSG RH SIDE COMPLETE*	\$150.00
	G209001L	ACT. CASE HSG LH SIDE COMPLETE*	\$150.00
2	G199001R	RH HOUSING ASSY, W/ARM*	\$105.00
	G199001L	LH HOUSING ASSY, W/ ARM*	\$105.00
3	G209020R	ACTIVE ARM RH SIDE*	\$55.00
	G209020L	ACTIVE ARM LH SIDE*	\$55.00
4	G199040	INACTIVE ARM RH SIDE*	\$55.00
	G199015	INACTIVE ARM LH SIDE*	\$55.00
5	G199039	CROSSBAR 42" *	\$82.00
6	G209030	RETAINING RING	\$1.00
7	G209040	LATCH LINK	\$12.00
9	G209060	LATCH SPRING	\$1.00
10	G199043	PIVOT BUSHING	\$1.00
11	G199013	PIVOT	\$9.00
12	G199044	RETAINING RING	\$1.00
14	G199038	SET SCREW	\$1.00
15	G199009	SPRING	\$3.00
16	G199045	SPRING RETAINER	\$1.00
17	G199014	DOGGING SCREW	\$3.20
18	88R60732	DOG KEY 7/32"	\$3.10
19	G199005	PINION	\$9.00
20	G209080	RETRACTOR	\$11.00
21	G199011	SPRING PIN	\$1.00
22,8,13,20,6	G209090R	BACKPLATE (OPP. OF SHOWN)	\$36.00
22,8,13,20,6	G209090L	BACKPLATE (SHOWN)	\$36.00
23	G199010	ALLEN WRENCH	\$1.00
24	G2090100	SCREW	\$1.50
25	G199002	STUD	\$3.00
26	G199012	SCREW	\$2.60
27	G199046	BUSHING	\$2.25
29	G199007	SPRING	\$3.00
30	G199006	RETAINER	\$3.00

***SPECIFY FINISH (ALUM-SILVER OR DARK BRONZE-BROWN)**

<p>P.O. BOX 2010, BIRMINGHAM, MI 48012-2010 CALL: 1-800-642-2403 FAX: 1-800-642-2406 ASK FOR: GREG</p>
